

SUN ODYSSEY 54^{DS}

Defining the Modern Deck Saloon Often copied, but never surpassed

*A world-class cruising yacht
built around three concepts :*

Volume

Seaworthiness

Advanced Systems



JEANNEAU YACHTS



JEANNEAU YACHTS

SPECIFICATIONS

Overall Length	16,75 m / 54' 11"
Hull Length	16,38 m / 53' 8"
L W L	14,79 m / 48' 6"
Max Beam	4,87 m / 15' 11"
Light displacement	17955 kg / 39584 lbs
Standard keel weight	5000 kg / 11023 lbs
Standard keel draft	2,30 m / 7' 6"
Shoal keel weight	5400 kg / 11905 lbs
Shoal keel draft.....	2,00 m / 6' 6"
Height above LWL	22,50 m / 73' 10"
Engine.....	YANMAR 4JH4 HTE : 110 Hp / 80,9 Kw
Cabin.....	3/4/5
Berths.....	6-12
Fuel capacity	410 l / 108 US gal
Water capacity	930 l / 246 US gal
Fridge capacity	280 l / 74 US gal
I	20,05 m / 65' 9"
J	5,90 m / 19' 4"
P	18,25 m / 59' 11"
E	5,85 m / 19' 2"
Furling mainsail (vertical battens)	57,50 m ² / 619 Sq ft
Furling mainsail	54,0 m ² / 581 Sq ft
Classic mainsail	61,40 m ² / 661 Sq ft
Furling genoa	80,5 m ² / 866 Sq ft
Spinnaker	190 m ² / 2044 Sq ft
Asymmetrical spinnaker.....	163 m ² / 1754 Sq ft
Sail area	138 m ² / 1485 Sq ft
Classic Sail area (Option)	148 m ² / 1593 Sq ft
CE category / Catégorie CE.....	A 8-13/13/16 Pers
Design / Architecte.....	J.Fauroux / V.Garroni

Jeanneau Design

INVENTORY

CONSTRUCTION

- HULL : Solid polyester / fiberglass hull. Wood fiberglass frame
- Reinforced Kevlar®
- Reinforced polyester engine bed.
- DECK : Balsa sandwich deck for rigidity and insulation.
- Deck liner
- KEEL : Epoxy encapsulated cast-iron keel : 2.30 m - 5000 kg
- Optional shorts keel, epoxy encapsulated cast-iron : 2.00 m – 5400 kg
- WOODWORK : Hand-selected blond teak

DECK HARDWARE

- Stainless steel double sheave bow fitting
- Open bow pulpit
- Stainless steel stern pulpit with buoy bracket and flagstaff holder
- Double lifelines – port and starboard lifeline gates
- Teak rubrail with built-in chocks
- 6 mooring cleats with 8 stainless steel chocks
- Anchor locker
- 1500 W 24v deck-mounted electric windlass
- Spinlock jammers and Harken turning blocks for halyards and control lines
- 2 Harken 70.2 STC cockpit coaming winches for genoa sheets
- 2 Harken 46.2 STC roof winches for the main, genoa and spinnaker
- 2 Harken genoa sheet tracks with adjustable ball-bearing Harken fairleads
- Genoa sheet turning blocks
- Harken adjustable mainsail traveler on roof
- Folding padeyes on deck (2 ≈ 3)
- Padeye for spinnaker pole downhaul
- Fiberglass halyard cover, roof handrails, companionway and cockpit handrails

COCKPIT / STERN PLATFORM

- Twin-level cockpit, teak batten seats and floor, two side lockers with gas lifting shocks
- Central locker for liferaft or storage, gas locker for 2 bottles
- Two large lockers under helm seats, access to steering system
- 2 steering wheels, leather wheel covers, compass with stainless steel guard
- Engine control on starboard steering console
- Cockpit table with folding sides, central storage, cup holder
- Stainless steel fiddle and handrail with light on cockpit table
- Room for electronics on each helm console and under cockpit table
- Teak batten stern platform steps and bottom
- Hot and cold cockpit shower, inlet for shore water
- Folding swim ladder with teak steps and cover
- Watertight stereo loudspeakers

STEERING

- Twin steering wheels, self-aligning rudder bearings
- Stainless steel cable steering, moulded aluminium quadrant
- Fibreglass rudder, stainless steel frame and shaft
- Rudder tube fibreglassed to hull

MAST / RIGGING

- Keel-stepped furling mast, fractional
- Triple spreaders, through-mast connection
- Discontinuous wire rigging
- Genoa furler, above-deck drum
- Rigid boom vang, all halyards led to Spinlock blockers in cockpit
- Harken mast step blocks on deck fitting
- Watertight mast passage deck fitting
- Removable mast casing for access to cable connections
- Folding mast steps, deck lighting under spreaders
- Boom topping lift, mainsail halyard, genoa halyard, spinnaker halyard
- Set of high-quality mainsail and genoa sheets
- Flag halyard strap-eyes

SAILS

- Furling mainsail with vertical battens for optimal surface area
- Furling genoa with foam luff and UV protection strip

WINDOWS' VENTILATION AND CURTAINS

- Eight fixed hull ports with curtains in cabins and roman blinds in salon
- Six opening cockpit ports with curtain tracks
- Twelve forward opening deck hatches with blinds
- Two dorade boxes with stainless steel guards
- Two lateral roof windows with interior pleated blinds
- Two-section front window with pleated blind
- Roller shades on all deck hatches

INTERIOR LAYOUT

SALON AND LOUNGE

Wide U-shaped salon to starboard with :

- Central bench seat with drawer and handrail
- One piece salon table with fiddles and central storage compartment
- 2 removable table legs to transform table into double berth (optional)
- Upper storage lockers, storage under seats

Lounge area to port with :

- Two angled seats with central bar furnishing and removable cocktail table
- Upper storage compartment, bookshelves in front of hull ports
- CD/MP3 player in forward corner cabinet and speakers

GALLEY

- Galley located on port side on slightly lower level, one step down
- High-quality resin countertop with: icebox access door, folding stove cover, dish drain, double sink with covers
- 37 US gal refrigerator, 12v seawater cooled compressor
- Stainless steel front-loading refrigerator door, shelves, storage bins
- 37 US gal icebox, top loading, with storage bins
- Fresh and seawater foot pump
- Upper shelf furnishings for microwave, dishes, and storage
- Ventilation hood with venting over the stern
- 4 burner stove with thermostatically controlled oven and electric ignition
- Three cutlery drawers, trash basket on sliding rail
- Storage locker on aft bulkhead
- Access to thru-hulls behind salon seat backrest
- Glass divider between galley and salon
- Mixer tap with flexible hose
- Stainless steel handrail with leather wrap

NAVIGATION STATION

- Main electrical panel 12v and 110v, with access to connections
- Curved teak batten navigator seat with support, storage compartment
- Side storage with bookshelf
- 4 drawers on left side, large table with storage, and dedicated computer compartment
- Room for radar screen chart plotter
- Deep foul weather gear locker behind navigator seat
- Access to service batteries under floorboards
- Stainless steel hand rail with leather wrap

LIGHTS AND ELECTRICITY

- Chrome and stainless steel flush overhead lights
- On/off switches in salon and cabins
- Indirect halogen lighting under side decks in salon
- One 110v and 12v outlet per cabin
- Three 110v outlets in owner's cabin
- Other 110v outlets : galley (2), salon (1), nav station (1)
- Courtesy lighting under stairs in salon and companionway

COMPANIONWAY AND HULL ACCESS

- 2 handrails, solid teak to either side of companionway
- Slotted varnished teak steps with nonskid strips
- Plexi companionway hatch cover, removable plexi hatch door with storage
- Access to front of engine via two panels on lifter arms
- Rear engine access by three removable panels in aft cabin
- Battery switch access panel on port side of companionway
- Access trap to generator hold on lifter arms
- Salon access traps to tanks, bilge, pumps, waterheater

CABINS

DEFINITION OF THE 2 AFT CABINS

- Lined and insulated bulkhead between cabins
- PREMIUM double density foam mattresses with bed covers
- Each double berth is transformable into two single berths
- Wood hull liner, light-coloured fabric ceiling liner
- Hanging locker and under berth storage, side shelf along hull
- Fixed teak floorboards with access panels

DEFINITION OF THE 2 FORWARD TRANSFORMABLE CABINS

- Removable longitudinal bulkhead for transformation to island berth
- PREMIUM double density foam mattresses with bed covers
- Drawers under berth
- Wood hull liner, light-coloured fabric ceiling liner
- Hanging locker and under berth storage, side shelf along hull
- Fixed teak floorboards with access panels
- Storage for modular pieces under berth

DEFINITION OF THE 3 FORWARD TRANSFORMABLE CABINS

- Direct access from salon to forward portside head
- Removable longitudinal bulkhead between the two cabins
- Creation of a "master cabin" with side access to the starboard double berth and transformation of the single berths to a bench seat to port.

- **Double cabin on starboard side** with hanging locker, PREMIUM mattress, drawers, and access to forward washroom
- Storage on side of hull or optional additional raised berth
- Wood hull liner, light-coloured fabric ceiling liner

- **Single cabin to port** with 2 single, superposed berths (upper berth folds down)
- Storage under berth
- Side shelf along hull

- **A double cabin** with V-berth, hanging locker and storage in the bow compartment
- Side shelves on hull, room for bow thruster

WASHROOMS : 2 AFT CABINS, 2 AND 3 FORWARD CABIN VERSIONS

- Moulded polyester washroom furnishing
- Marine toilet with manual pump
- Hot and cold water shower tap
- Shower drain pump with switch
- Stainless steel washbasin with synthetic resin decorative trim
- Storage under sink, access to thruhulls
- Clothes hook, mirror, towel ring, toilet paper holder
- Hanging locker over toilet (location for holding tanks)
- Plastic shower grate, folding seat over toilet
- Stainless steel counter handrail
- Holding tank (12 US gal)

AFT OWNER'S CABIN

- Double berth 5' 3" x 6' 8" with mattress battens
- PREMIUM double density foam mattress with bed cover
- Teak hull liner with shelf
- Teak flooring
- Tall hanging locker to starboard, short locker to port
- Storage lockers on both sides of beds, with bookshelves
- Shelves on sides
- Vanity with seat and mirror to starboard, seat to port
- Storage under seats
- Concealed electronic safe
- TV and video pre-wiring
- CD/MP3 radio and speakers
- Overhead halogen lights with switches, LED reading lights at head of berth
- Mirror on forward bulkhead
- Opening ports

WASHROOM AFT OWNER'S CABIN

- **To port :**
- Separate shower with teak seat and teak grating
- Shower with hot/cold thermostatic mixer
- Towel cupboard
- Storage under sink

- **To starboard :**

- Identical washroom as in the two aft cabin versions
- Plus : teak grating

FORWARD OWNER'S CABIN

- Double berth, 5' 3" x 6' 8", mattress battens
- PREMIUM double density foam mattress with bed cover
- Teak hull liner, storage shelves with door
- Drawers under berth, change drawer on side
- Teak floorboards
- Large hanging locker to starboard
- Large cupboard with shelves and hanging locker to port

- **To port :**

- Desk with seat, mirror and storage
- Concealed electronic safe
- TV and video pre-wiring
- CD/MP3 radio and speakers
- Halogen overhead lights, with switches and LED reading lights at head of berth
- Mirror on bulkhead

WASHROOM FORWARD OWNER'S CABIN

- Same as double cabin version, with additional :
- Shower with hot/cold thermostatic mixer
- Teak grating
- Stainless steel handrail

Sail locker (except for 3 forward transformable cabin version)

- White hull side panel liners
- Access ladder with storage compartments
- Lower storage compartment, lateral hull shelves
- Access to electric windlass motor
- Waterproof bulkhead between forward cabin and sail locker
- Storage racks for mooring lines and fenders

Optional skippers cabin (in sail locker)

- Upper cross berth, lower longitudinal berth
- Furnishings include sink, hot and cold shower, mirror
- Marine toilet under lower berth (folding berths)
- Electric shower pump, overhead and reading lights
- Roller shade on deck hatch
- Closed-cell foam mattress and mildew-resistant covers

SYSTEMS

ENGINE

- Mounted on fibreglass bed with engine well and ventilation
- Soundproof plastic film insulation and protected edges
- Filter inspection panel at foot of companionway
- Access to engine and generator raw-water intake thruhulls in passageway
- Structurally sealed metal shaft strut and fibreglass shaft log
- Stainless steel prop shaft, Ø 35 mm, dripless stuffing box, fixed three-blade propeller
- Water exhaust built into engine bed, stainless steel exhaust aft
- Independent engine starting battery, forced ventilation
- Fuel/water separator

ELECTRICAL CIRCUIT

- One 12V/80A engine alternator
- Twin input -triple output battery charge distributor
- One 55 A/h AGM engine battery
- One 12V battery park, four 80 A/h Dryfit service batteries
- One 24V battery park, two 55 A/h AGM electric windlass batteries
- One 12V/24V transformer for the 24V battery park
- One 110V shore power inlet with 12V/60A charger and circuit breaker
- One positive engine battery switch, one for service
- Remote control battery switches for the 24V battery bank
- One general negative battery switch
- 12V electrical panel at the chart table with circuit breakers
- 12V charge ammeter, 12V voltmeter, 12V charge circuit selector
- 110V electrical panel with circuit breakers, 110V voltmeter
- 110V selector switch: dock, generator (option), inverter (option)

PLUMBING

- Hot and cold pressure water, rigid plastic tubing
- "Heavy-duty" water pump, 12 US gal hot water heater
- Stainless steel water tanks under the salon, with water fill and separate vents
- Chrome faucets with shower taps in washrooms
- Water meter, separate water gauge for each tank
- Showers with individual electric pumps with on/off switch
- Manual marine toilets

OPTIONS

MAST OPTIONS

- Standard furling mast painted white
- Releasable inner forestay
- Electric genoa furling unit
- Spinnaker rigging for symmetrical or asymmetrical spinnaker

Classic mast

- Full-batten triradial polyester/mylar sandwich mainsail
- Triradial cut polyester/mylar sandwich mainsail genoa
- Harken system B mast track and battcars
- 2 automatic reefs, 3rd classic reef
- Mainsail cover and adjustable lazy jacks

HULL AND DECK OPTIONS

- Teak deck
- Painted hull
- Luxury chrome hardware: dorades, compass, deck fills, turnbuckle covers
- Large classic dodger
- Classic bimini
- Foredeck sun mattress
- Cockpit cushions with back rests
- Exterior protective covers for windows including set of winch and steering wheel covers
- Electric winches on coachroof and coamings
- Hydraulic gangway
- Retractable davits

PLUMBING OPTIONS

- 12v electric toilets
- Deck washdown pump

ENGINE AND OTHER OPTIONS

- Max Prop folding propeller
- Gori folding propeller
- Shaft cutter
- Fuel tank in place of water tank, with 12v transfer pump

OPTIONAL LAYOUTS

- Deluxe folding salon table with glass holder
- Double berth (not available with deluxe salon table)
- Lounge seats instead of central bench seat
- Leather salon upholstery
- Alcantara salon upholstery

ELECTRICAL AND ACCESSORY OPTIONS

- ONAN 9 KW / 1500 rpm genset 110v
- 24v battery bank combining two 55A/h AGM batteries and one 24v charger
- 24v bow thruster
- 24v electric winch on roof
- 24v electric genoa winches
- 110v air conditioning
- Diesel pulsed air heater, twin units, with: outlet in each cabin, two in the salon, one in each washroom
- Pre installation for washer/drier
- Pre installation for microwave
- 12v freezer unit with heat exchanger on exterior of hull
- Pre installation for LCD TV in nav station that can serve as GPS screen or entertainment center
- A range of electronic navigation instruments, GPS and autopilot options



Deck plan



Owner's cabin aft
with 3 convertible cabins forward

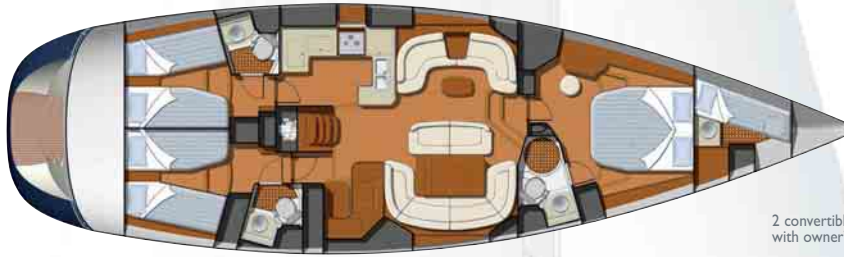

2 convertible cabins aft
with owner's cabin forward



2 convertible cabins aft
with 2 convertible cabins forward

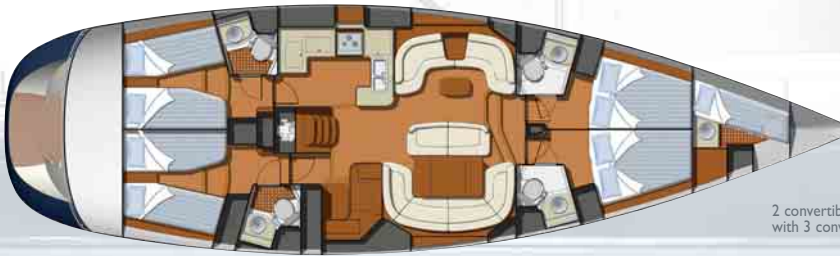

2 convertible cabins aft
with 3 convertible cabins forward



JEANNEAU YACHTS

KEVLAR

